

MODEL # 9048 FLOOR PEDESTAL WITH 12" FOUR TIER COUNTER DISPLAY

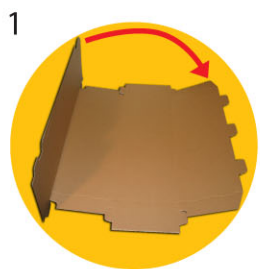

1
FOLD OVER

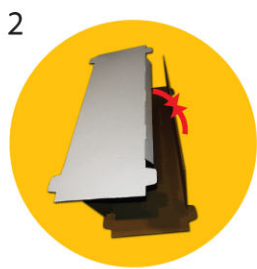

2
BRING TOGETHER

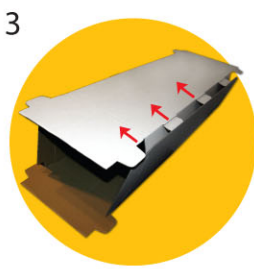

3
CONNECT

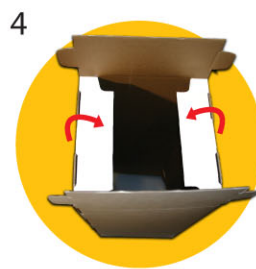

4
FOLD IN PANELS

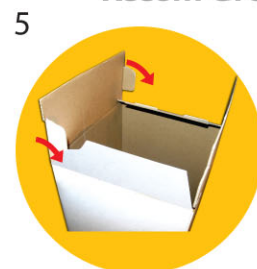

5
FOLD DOWN WINGS



6
SLIDE WINGS IN SIDES



7
REPEAT STEP 6



8
REPEAT STEPS 4-7 (OTHER END)

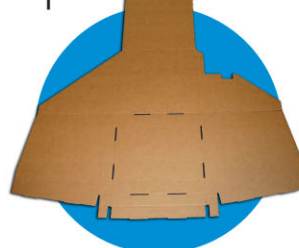

1
LAYOUT AS SHOWN

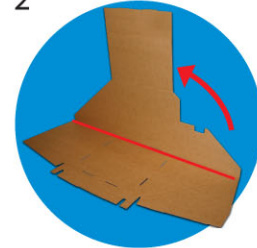

2
FOLD TOP PART UP

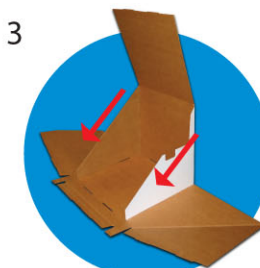

3
FOLD SIDES IN

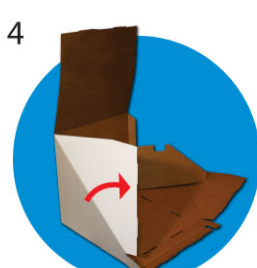

4
FOLD PANEL IN



5
FOLD IN WINGS

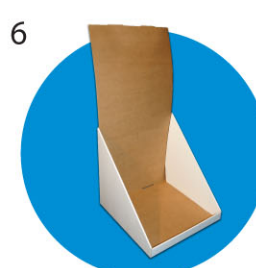

6
FOLD OVER AND INTO SLOT



7
FOLD IN AND TUCK IN

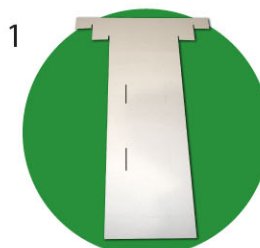

1
LAYOUT AS SHOWN

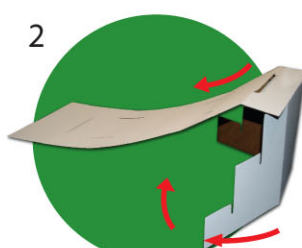

2
FOLD DOWN TOP & FOLD SIDES IN

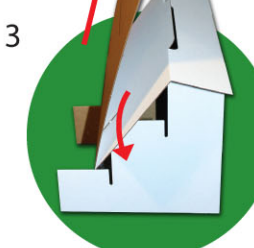

3
FOLD TOP AGAIN & SLIDE IN SLOT

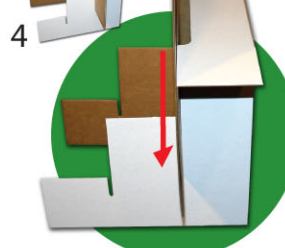

4
SLIDE FOLDED PART IN SLOT

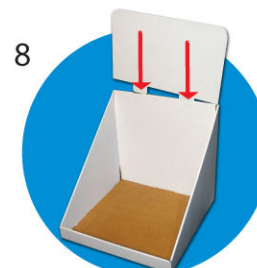

8
CONNECT

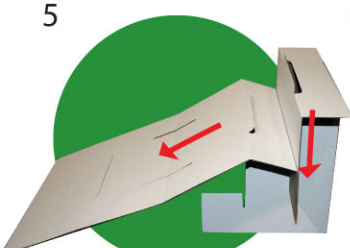

5
FOLD DOWN TOP

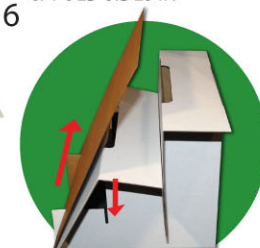

6
REPEAT STEP 3

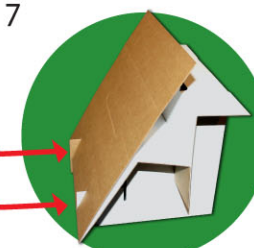

7
SLIDE THROUGH THE SLOTS

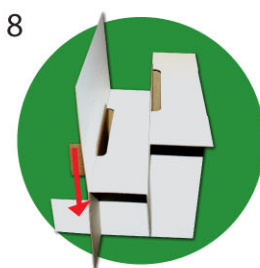
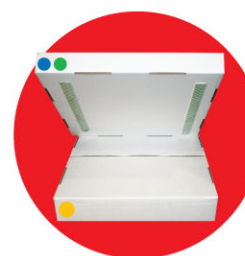

8
PUSH IN ALL THE WAY

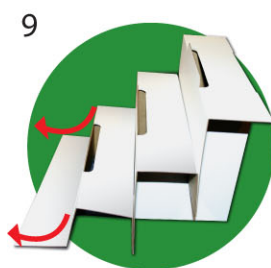

9
FOLD DOWN FLAP



10
PLACE IN TIER

● PEDESTAL
● TIER

