

# MODEL # 9047 FLOOR PEDESTAL WITH 12" THREE TIER COUNTER DISPLAY

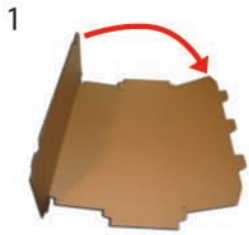

1 FOLD OVER



2 BRING TOGETHER

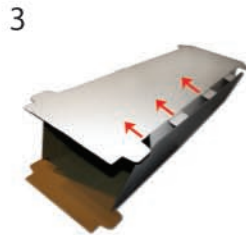

3 CONNECT

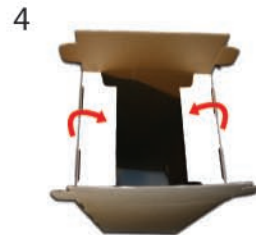

4 FOLD IN PANELS



5 FOLD DOWN WINGS



6 SLIDE WINGS IN SIDES



7 REPEAT STEP 6



8 REPEAT STEPS 4-7 (OTHER END)

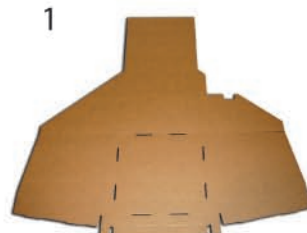

1 LAYOUT AS SHOWN

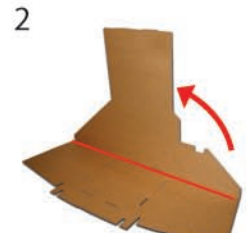

2 FOLD TOP PART UP

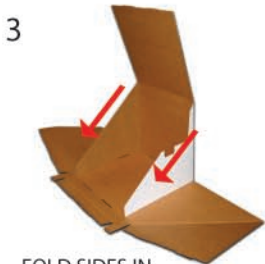

3 FOLD SIDES IN

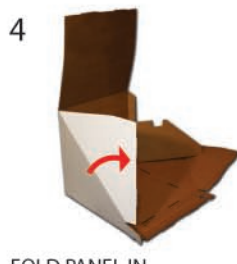

4 FOLD PANEL IN



5 FOLD IN WINGS

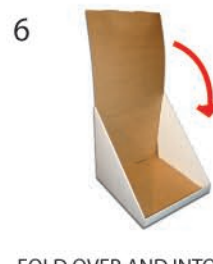

6 FOLD OVER AND INTO SLOT



7 FOLD IN AND TUCK IN



1 LAYOUT AS SHOWN

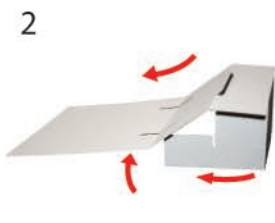

2 FOLD DOWN TOP & FOLD SIDES IN

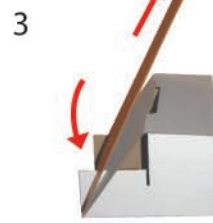

3 FOLD TOP AGAIN & SLIDE IN SLOT

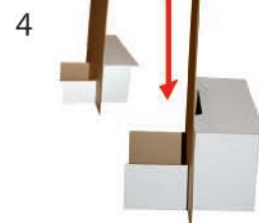

4 SLIDE FOLDED PART IN SLOT



8 CONNECT



5 FOLD DOWN TOP



6 FOLD DOWN FLAP



7 PLACE IN TIER



● PEDESTAL  
● TIER

